

**STRAIGHT PLUG CRIMP TYPE**

**R129.083.000**

**CABLE 4/75**

Series : V1.6-5.6

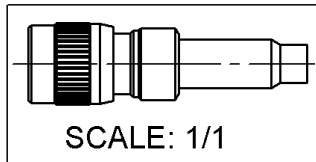
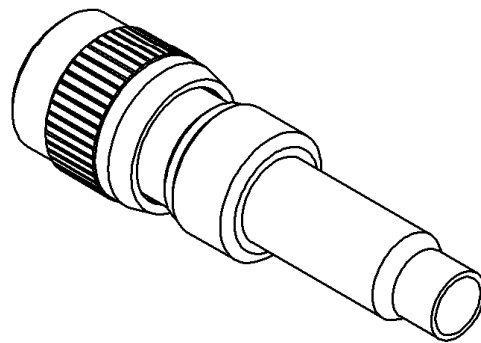
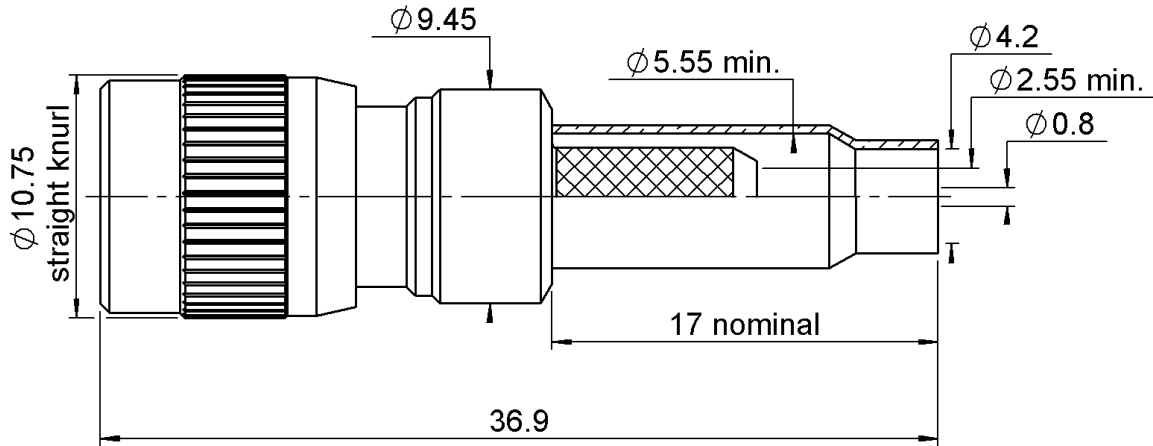

All dimensions are in mm.

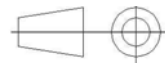

| COMPONENTS     | MATERIALS | PLATING ( $\mu\text{m}$ ) |
|----------------|-----------|---------------------------|
| BODY           | BRASS     | NICKEL 2                  |
| CENTER CONTACT | BRASS     | GOLD 1.3 OVER NICKEL 2    |
| OUTER CONTACT  | BRONZE    | GOLD 1.3 OVER NICKEL 2    |
| INSULATOR      | PTFE      |                           |
| GASKET         | -         |                           |
| OTHERS PARTS   | BRASS     | NICKEL 2                  |
| -              | -         | -                         |
| -              | -         | -                         |

Issue : 0827 G

In the effort to improve our products, we reserve the right to make changes judged to be necessary.



**STRAIGHT PLUG CRIMP TYPE**

**R129.083.000**

**CABLE 4/75**

Series : **V1.6-5.6**

**PACKAGING**

| Standard | Unit | Other             |
|----------|------|-------------------|
| <b>1</b> | -    | <b>Contact us</b> |

**SPECIFICATION**

**ELECTRICAL CHARACTERISTICS**

|                                 |               |                             |
|---------------------------------|---------------|-----------------------------|
| Impedance                       |               | <b>75</b> Ω                 |
| Frequency                       |               | <b>0-1</b> GHz              |
| VSWR                            | <b>1.22</b> + | <b>0</b> x F(GHz) Maxi      |
| Insertion loss                  |               | <b>NA</b> √F(GHz) dB Maxi   |
| RF leakage                      | - (           | <b>NA</b> - F(GHz)) dB Maxi |
| Voltage rating                  |               | <b>330</b> Veff Maxi        |
| Dielectric withstanding voltage |               | <b>1500</b> Veff mini       |
| Insulation resistance           |               | <b>5000</b> MΩ mini         |

**CABLE ASSEMBLY**

| Stripping | a | b | c  | d | e  | f |
|-----------|---|---|----|---|----|---|
| mm        | 4 | 9 | 15 | 0 | 11 | 0 |

Assembly instruction :

Recommended cable(s)  
L910/34

**MECHANICAL CHARACTERISTICS**

|                            |  |                     |
|----------------------------|--|---------------------|
| Center contact retention   |  |                     |
| Axial force – Mating end   |  | <b>27</b> N mini    |
| Axial force – Opposite end |  | <b>27</b> N mini    |
| Torque                     |  | <b>NA</b> N.cm mini |

Characteristics indicated on this data sheet are those that can be achieved with the highest performance cable. Intrinsic limitations of the cable may diminish the performance of the assembly

Cable retention

|            |                   |
|------------|-------------------|
| - pull off | <b>100</b> N mini |
| - torque   | <b>NA</b> N.cm    |

**TOOLING**

|                    |               |             |
|--------------------|---------------|-------------|
| Recommended torque |               |             |
| Mating             | <b>NA</b>     | N.cm        |
| Panel nut          | <b>NA</b>     | N.cm        |
| Clamp nut          | <b>NA</b>     | N.cm        |
| A/F clamp nut      | <b>0.0000</b> | mm          |
| Mating life        | <b>500</b>    | Cycles mini |
| Weight             | <b>7.96</b>   | g           |

| Part Number  | Description                 | Hexagon          |
|--------------|-----------------------------|------------------|
| R282.281.000 | CRIMPING TOOL               | 2x4 pts (pos. 5) |
| R282.968.000 | POSITONER FOR CRIMPING TOOL |                  |
| R282.223.000 | CRIMPING TOOL               | 5.41             |
| R282.293.000 | CRIMPING TOOL M22520/5-01   |                  |
| R282.235.011 | CRIMPING DIES M22520/5-11   | 5.40             |

**ENVIRONMENTAL**

|                       |                 |           |
|-----------------------|-----------------|-----------|
| Operating temperature | <b>-55/+155</b> | ° C       |
| Hermetic seal         | <b>NA</b>       | Atm.cm3/s |
| Panel leakage         | <b>NA</b>       |           |

**OTHER CHARACTERISTICS**

Issue : **0827 G**

In the effort to improve our products, we reserve the right to make changes judged to be necessary.



**STRAIGHT PLUG CRIMP TYPE**

**R129.083.000**

**CABLE 4/75**

Series : V1.6-5.6

**COMPONENTS**

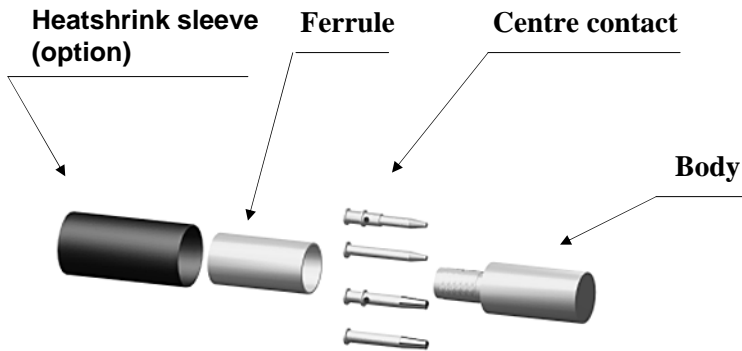

**STRIPPING DIMENSIONS**

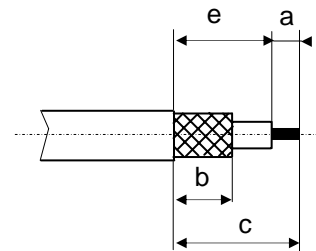

**1**

Slide the heatshrink sleeve onto the cable.  
Slide the ferrule onto the cable.  
Strip the cable.



**4**

Slide the cable into the body until it bottoms against insulator.

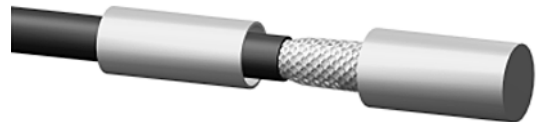

**2**

Slide the centre contact on until it bottoms against the cable dielectric.  
Crimp the centre contact with crimping tool  
Or solder the center contact and clean the solder area.

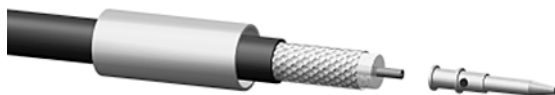

**5**

Slide the ferrule over the braid.  
Crimp the ferrule with crimping tool.



**3**

Fan the braid.



**6**

Cut the excess of braid if necessary.  
Slide the sleeve over the ferrule and heatshrink it in place.



Issue : 0827 G

In the effort to improve our products, we reserve the right to make changes judged to be necessary.

